

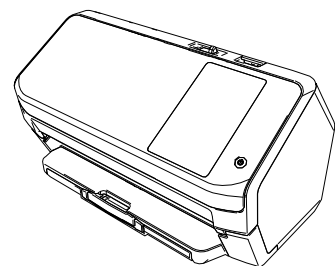

FUJITSU Image Scanner/FUJITSU Scanneur d'image fi-7300NX Getting Started/Instructions préliminaires

1



Scanner
Scanneur

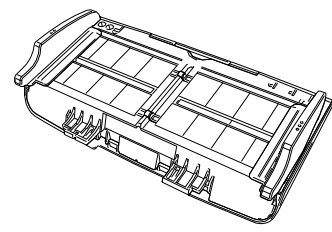

ADF paper chute
(feeder)
Plateau d'alimentation de l'AAD
(chargeur)

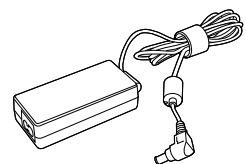

AC adapter
Adaptateur CA

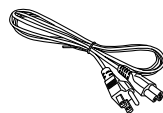

AC cable (*)
Câble CA (*)



USB cable
Câble USB

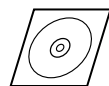

Setup DVD-ROM
DVD-ROM d'installation

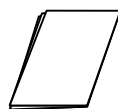

Safety Precautions
Consignes de sécurité

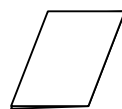

Getting Started
(This sheet)
Instructions préliminaires
(Cette page)

(*) The contents may vary depending on the country and the model purchased.
Le contenu risque de différer selon le pays d'achat et le modèle.
Je nach Land und Modell können sich die Inhalte unterscheiden.
I contenuti possono variare a seconda del Paese e del modello acquistato.
Los contenidos pueden diferir de acuerdo al modelo y al país donde adquirió.
Содержимое может изменяться в зависимости от страны и выбранной модели сканера.
O conteúdo pode variar dependendo do país e do modelo adquirido.

2

1

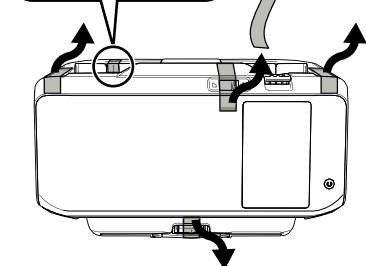
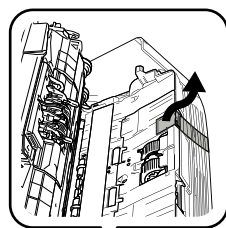

2

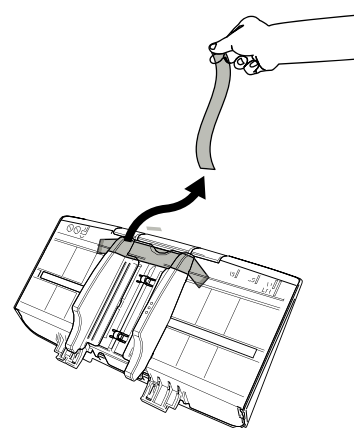

3

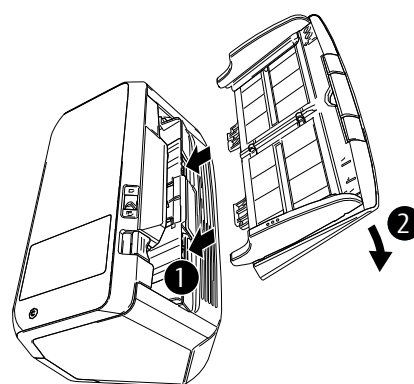

3

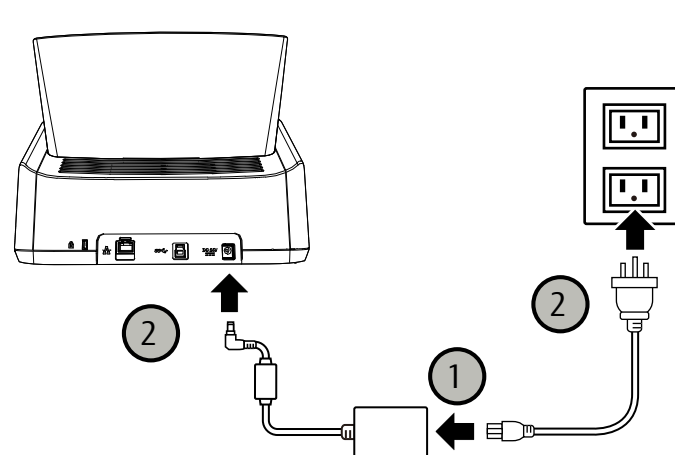

3

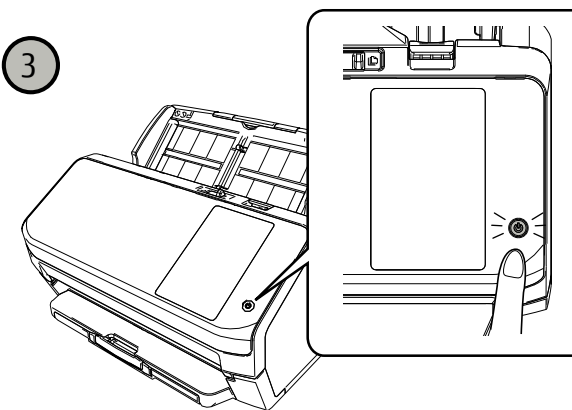

4

Check the operation and connection methods./Vérifiez le fonctionnement et les méthodes de connexion.

Operating with a Computer/Fonctionnement avec un ordinateur



Wifi

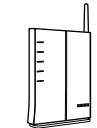
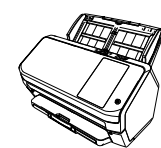

Wired LAN
Réseau LAN câblé

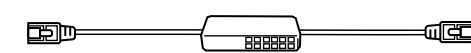
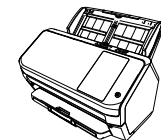

USB

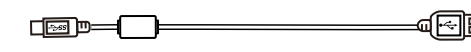
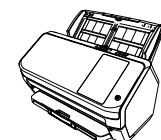

Operating with PaperStream NX Manager/Fonctionnement avec PaperStream NX Manager



Wifi

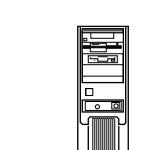
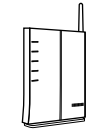
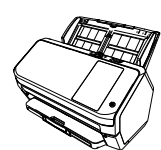

Wired LAN

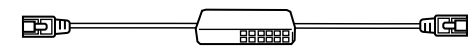
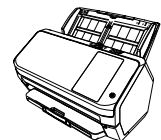

PaperStream
NX Manager

5

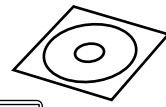

Setup DVD-ROM (*)
DVD-ROM d'installation (*)

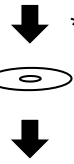

* Please keep this disc safe as it will not be reissued.
 Conservez ce disque dans un endroit sûr car ce sera votre seul unique exemplaire.
 Bitte bewahren Sie diese Disk sicher auf, da keine Neuauflage erhältlich sein wird.
 Non danneggiare il disco perché non verrà ridistribuito.
 Mantenga seguro este disco, ya que no se emitirá de nuevo.
 Так как диск не будет переиздан, пожалуйста, бережно храните да нный диск.
 Mantenha o disco em um local seguro. A segunda via do disco não pode ser emitida.

1 Click the scanner model name to be used (if the window for selecting a model name is displayed).
 Cliquez sur le nom du modèle de scanner à utiliser (si la fenêtre de sélection d'un nom de modèle s'affiche).
 Klicken Sie auf den Namen des verwendeten Scannermodells (wenn das Fenster zur Auswahl des Modellnamens angezeigt wird).
 Cliccare il nome del modello di scanner da utilizzare (se è visualizzata la finestra per la selezione di un nome del modello).
 Haga clic en el nombre de modelo del escáner que se va a utilizar (si se muestra la ventana para seleccionar un nombre de modelo).
 Нажмите имя модели сканера для использования (если отображается окно выбора названия модели).
 Clique no nome do modelo do scanner a ser usado (se a janela para seleção de um nome do modelo for exibido).

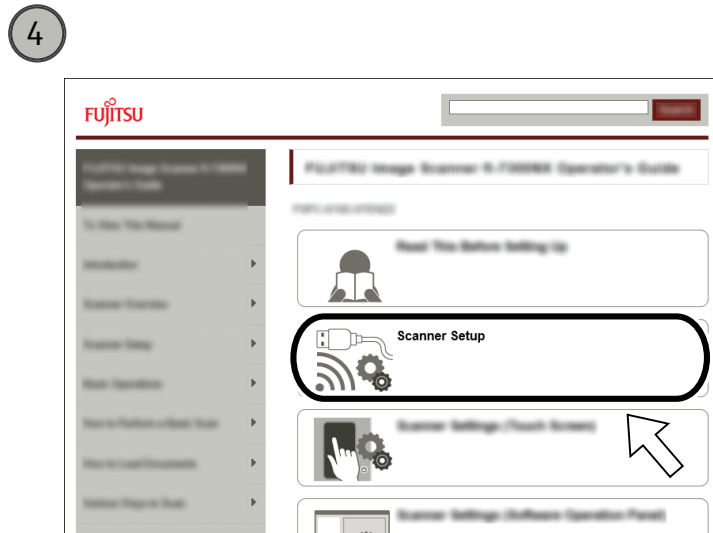
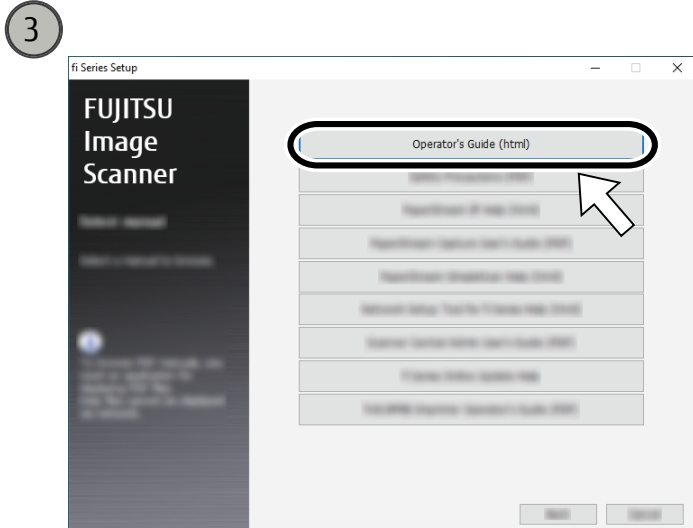
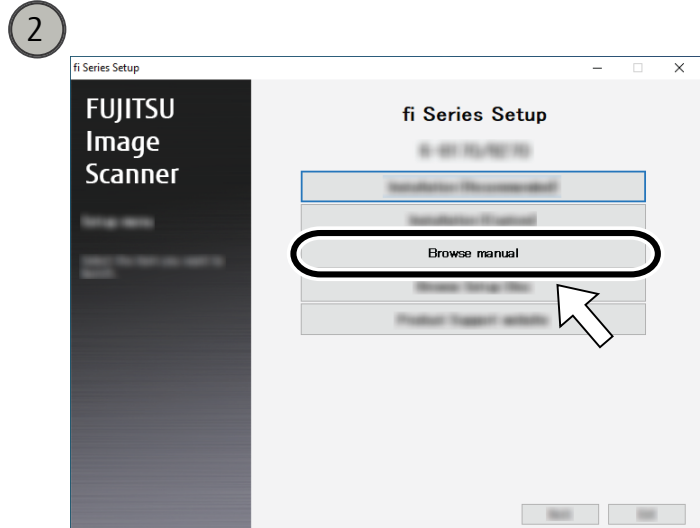

Refer to "Scanner Setup" in the Operator's Guide.
 Reportez-vous à la rubrique "Configuration du scanner" du Guide d'utilisation.
 Siehe "Scanner-Setup" im Bedienungshandbuch.
 Consultare "Installazione dello scanner" nella Guida dell'operatore.
 Consulte "Instalación del escáner" en la Guía del usuario.
 Смотрите "Настройка сканера" в Руководстве по эксплуатации.
 Consulte "Configuração do scanner" no Manual de instruções.

The full text of the FCC of conformity is available at the following internet address:
<http://imagescanner.fujitsu.com/r/cert/>

Le texte complet de la FCC de conformité est disponible à l'adresse internet suivante:
<http://imagescanner.fujitsu.com/r/cert/>